

EXPECT MORE. CHOOSE READING.



CLASSIC II™ SERVICE BODIES



Spacemaker® model shown with the C2-50 options package

Expect more standard features and more exclusive options with the Classic II™!



Manufactured With Confidence

The service body that leads the industry

- **PATENTED** hidden hinges
- **EXCLUSIVE** standard features and option packages
- **LEGENDARY** quality and durability
- **TIMELESS** design, maximized for efficiency



There may be other service bodies, but there's

The Classic II offers an unbeatable combination of standard features, useful options, and the know-how of over 50 years of refinement. This service body is designed for efficiency today, and built to last for tomorrow.



A40-A60 Coating Weight Pressed Diamond Floor Plate Steel and Tailgate Inner Panel
Industry Exclusive A40-A60 Coating Weight Steel diamond surface provides additional corrosion protection & better traction. Patent Pending

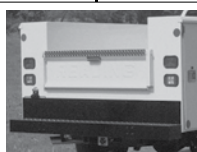

Slam Action Tailgate with a polished stainless steel handle and convenient pickup-style design. Equipped with rugged double-panel construction and durable stainless steel hardware.



Poached Anti-Slip Surface Bumper
Poached design provides slip resistant step surface.



Modern Rectangular Tail Lights
Provides modern look and are leak resistant.



Removable Stainless Steel Tailgate Knee Brace
Allows the tailgate to swing down completely.

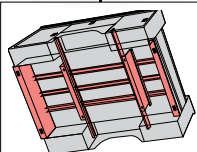

Rugged Understructure
Fully unitized welding, with U-beam girders braced and reinforced at all critical points. Acrylic E-coat primed and coated with a tough water-based undercoating that meets all environmental regulations.

only one Classic II™.



1 A40-A60 Coating Weight Steel

2 E-Coat Primer

3 Powder Coat Finish



Manufactured With Confidence



Spacemaker model shown with available options

The C2-50 Options Package

This Classic II is equipped with the C2-50 Options Package, a group of our most popular and most exclusive options. The C2-50 Options Package includes:



Latch-Matic® remote locking system with audible alarm



Bright finish aluminum treadplate guards on front body panels and on top of tailgate



Compartment lighting system (includes cargo bed light)



Extend-A-Shelf™ drawers with grab handles

Individual items from this package can be purchased separately



Heavy Duty Compartment Doors

18 Gauge outer door skin with double-paneled construction with internal reinforcement that makes this door the thickest and strongest door in the industry.

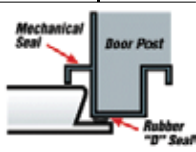

Exclusive Dual-Pro® Seal System

The patented design increases clear door openings in every compartment of the body. The large automotive quality bubble type seal and mechanical seal provide a dual line of defense against weather.



Patented Hidden Hinges

Industry exclusive overlapping door construction resists forcible entry. The robust and concealed hinge design provides protection against corrosion and does not require frequent lubrication or maintenance. Fully adjustable and easily replaced without damaging body or door.



Complete stainless Steel Rotary Locks

Attractive appearance with no exposed fasteners and rust resistant. Features a double bolted high quality locking cylinder, adjustable striker pins and an O-ring seal to prevent water intrusion.



Nitrogen Strut Door Holders

All vertical compartment doors are equipped with nitrogen strut door holders where the internal dampeners control the opening and closing.



Aluma-Fill®

Aluminum fuel fill receptacle protects the body from accidental nicks and scratches.



Latch-Matic® with optional audible alarm system

- One touch simultaneously locks or unlocks all compartments on the body
- Two high quality key fob transmitters with 25 ft. range
- Optional audible alarm is enabled by locking doors with the key fob transmitter
- Proven, automotive quality components with concealed wiring and hardware
- Compartment doors can be locked individually with keys (provided)
- Three year limited warranty on parts and service



Compartment lighting system

- Works in conjunction with the Latch-Matic system
- Lights are activated when compartment doors are unlocked and go off when doors are locked
- Programmed to go off automatically after 10 minutes
- Lights feature impact resistant Lexan lenses
- Additional light for cargo bed is also available

DRAWER UNITS



Extend-A-Shelf™

- Most economical compartment drawer system
- Three drawers with *patented* grab handles which permit easy one-handed operation and help secure drawers when compartment door is closed
- Shelves operate on 250 lb. capacity ball bearings



E-Z Slide

- Moderately priced compartment drawer system
- Smooth operating 250 lb. capacity full extension ball bearing slides
- Equipped with three drawers (single drawer models are available for horizontal compartments)
- Also available as a stand-alone 5-drawer module



Grip n' Glide

- Competitively priced compartment drawer system
- 250 lb. capacity drawers with full extension ball bearing slides
- Ergonomically designed grips provide single hand "grab & pull" operation of drawers
- Equipped with three drawers

Reading Bumper Options

Reading Bumpers are constructed of heavy-duty A40-A60 coating weight steel and are protected by acrylic E-Coat priming. They are offered in a wide array of styles and feature deck plate, safety step, or all-weather anti-slip surfaces.

Pooched anti-slip bumper

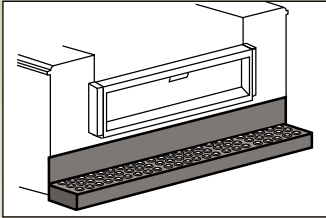

Lighted pooched anti-slip bumper

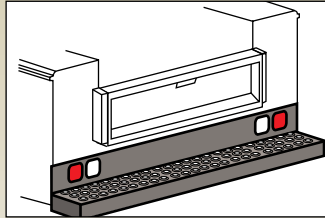

Pooched anti-slip bumper with recess

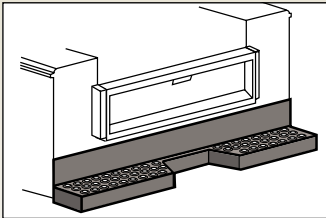

Lighted pooched anti-slip bumper with recess

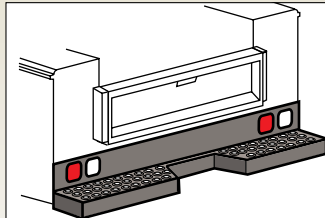

Deck plate step bumper

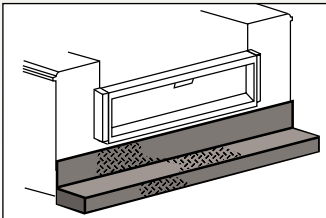

Deck plate step bumper with recess

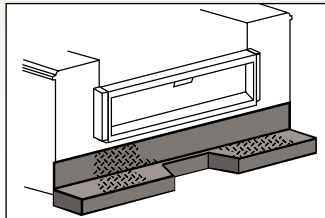

Safety step bumper

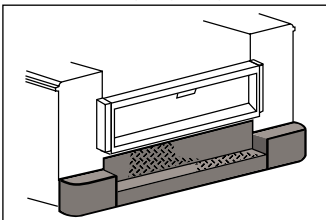

Safety step bumper with recess

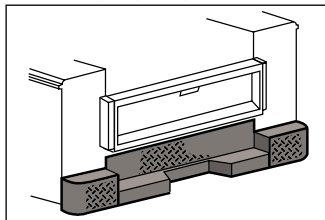

Frame Mount Bumpers with Pooched Anti-Slip Surface

Available only on certain models.

Single Wheel Bumper with L.E.D. lights

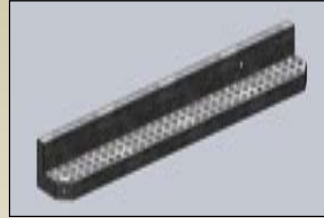

Dual Wheel Bumper with L.E.D. lights

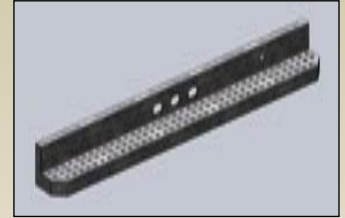

Single Wheel Recessed Bumper with L.E.D. lights

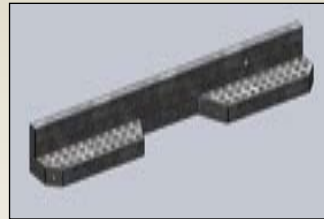

Dual Wheel Recessed Bumper with L.E.D. Lights



Powder Coating



- Polyester powder is sprayed on the body, then melted to form a highly durable white finish (other colors available)
- Resistant to corrosion, chemicals, humidity, scratches, chips, and impact
- Brighter finish
- Tolerant of UV exposure

Rhino Linings® Tuff Stuff®



- Available as a factory-installed option
- Offers watertight and airtight truck bed protection
- Prohibits rust, corrosion, and surface abrasion while providing a slip-resistant surface
- 1/8" Thick graphite gray coating application is very resistant to damage from impact



Standard Service Bodies

- For single and dual wheel configurations
- Available in 78", 98", 108", and 132" sizes
- Can be ordered with C2-50 Options Package (see opening spread)

Standard service body – 108SW ("A" side shown) with recessed tail lights and optional pooched anti-slip bumper



Spacemaker® Service Bodies

- Feature top-opening compartments which provide 15% more storage space
- New re-designed lids are reinforced and feature two pneumatic props and rotary catches with push-button release. This design permits easy one-handed closure from either end
- Available in same configurations and sizes as standard bodies
- Can be ordered with C2-50 Options Package (see opening spread) or with the C2-50A Options Package which features bright finish aluminum treadplate lids for Spacemaker compartments



Low Profile Service Bodies

- Body is 5" lower than standard bodies for better visibility
- Available in same configurations and sizes as standard bodies
- Spacemaker style also available
- Can be ordered with C2-50 Options Package (see opening spread) or with the C2-50A Options Package which features bright finish aluminum treadplate lids for Spacemaker compartments

Spacemaker low profile service body SLP108DW ("B" side shown) Model shown features Spacemaker compartments with recessed tail lights, optional removable overhead ladder rack, and deck plate step bumper with recess

ENCLOSURES FOR CLASSIC II™ BODIES

Need a service body with a bit more storage or perhaps an enclosed work space? Reading enclosed bodies are the answer. Equipped with spacious outside storage compartments and featuring a completely enclosed cargo and work area, Reading enclosed bodies offer the best of both worlds.

Panel Bodies

- Available in heights of 50", 60" and 72" for most models
- Rear doors close and lock securely with 2-point locking system
- Available in galvanized steel or in fuel-saving aluminum
- Protected by acrylic E-Coat priming
- Enclosed area has three full length shelves on each side (four shelves on 72 series) to provide carrying space for long-handled tools and equipment



**108DW panel body
50 series** ("B" side shown)
With optional recessed safety step bumper, and recessed tail lights.



**108DW tapered panel body
60 series** ("B" side shown)
With recessed tail lights and optional pooched anti-slip bumper

Spacemaster Bodies

- Available in heights of 48" and 57"
- Enclosed work area, plus four lift-up doors
 - Upper roadside compartments permit direct access from the interior
 - Upper exterior doors feature pneumatic struts and T-handle locks
- Available in galvanized steel or in fuel-saving aluminum
- Protected by acrylic E-Coat priming



**108DW Spacemaster Body
57 series** ("A" side shown) *With recessed tail lights and optional recessed safety step bumper*



Every Classic II model carries the Reading exclusive 6-year warranty.

DIMENSIONAL DATA: STANDARD BODIES – SINGLE WHEEL

Model	Approx. Weight		Cab-to-Axle	A	B	C	D	Approximate Compartment Clear Door Openings				
	Steel	Alum.						E	F	G	H	I
**78-SW▲	858#	472#	40"	18"	42"	18"	78"	12-1/2"x35-1/4"	40-1/2"x14"	12-1/2"x35-1/4"	56-1/2"x14"	12-1/2"x18-1/8"
**LP-78SW▲	818#	450#	40"	18"	42"	18"	78"	12-1/2"x30-1/4"	40-1/2"x9"	12-1/2"x30-1/4"	56-1/2"x9"	12-1/2"x18-1/8"
98-SW▲	1026#	563#	56"	28"	48"	22"	98"	22-1/2"x35-1/4"	46-1/2"x14"	16-1/2"x35-1/4"	66-1/2"x14"	16-1/2"x18-1/8"
*U98-SW▲	1026#	563#	56"	28"	48"	22"	98"	22-1/2"x35-1/4"	46-1/2"x14"	16-1/2"x35-1/4"	66-1/2"x14"	16-1/2"x18-1/8"
LP98-SW▲	976#	537#	56"	28"	48"	22"	98"	22-1/2"x30-1/4"	46-1/2"x9"	16-1/2"x30-1/4"	66-1/2"x9"	16-1/2"x18-1/8"
*ULP98-SW▲	976#	537#	56"	28"	48"	22"	98"	22-1/2"x30-1/4"	46-1/2"x9"	16-1/2"x30-1/4"	66-1/2"x9"	16-1/2"x18-1/8"
*U108-SW▲	1045#	575#	60"	34-3/4"	47"	26-1/4"	108"	29-1/4"x35-1/4"	45-1/2"x14"	20-3/4"x35-1/4"	69-3/4"x14"	20-3/4"x18-1/8"
*ULP108-SW▲	990#	545#	60"	34-3/4"	47"	26-1/4"	108"	29-1/4"x30-1/4"	45-1/2"x9"	20-3/4"x30-1/4"	69-3/4"x9"	20-3/4"x18-1/8"

Installers notes:

- * Universal mounting
- ** E-Z mounting installation not available on these models
- ▲ Equipped with spring shackle offsets (see diagrams below). Contact your Reading Distributor for dimensions of offsets

Models 78-SW, 98-SW, U98-SW, and U108-SW

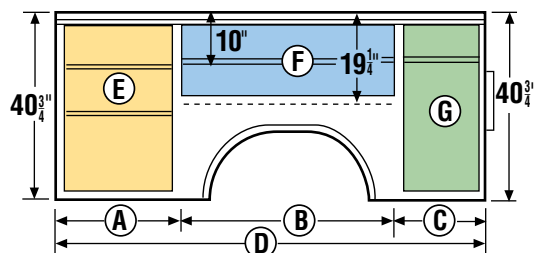

"A" Compartment Layout

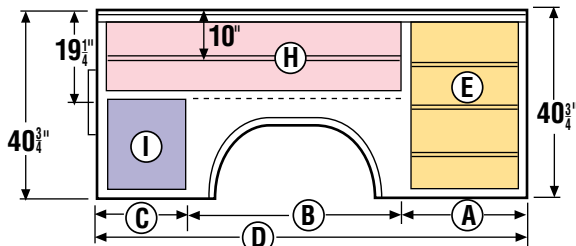

"B" Compartment Layout

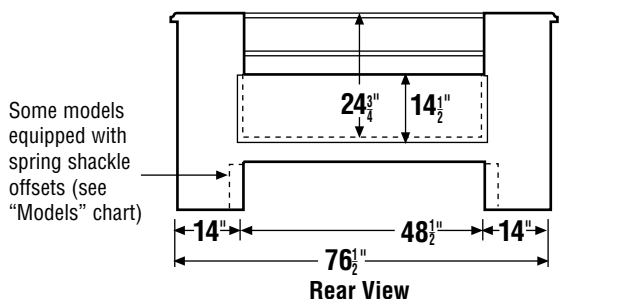

Rear View

Some models equipped with spring shackle offsets (see "Models" chart)

Low Profile Models LP78-SW, LP98-SW, ULP98-SW, and ULP108-SW

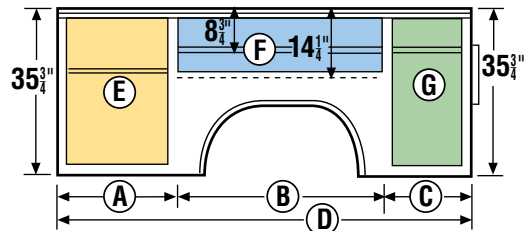

"A" Compartment Layout

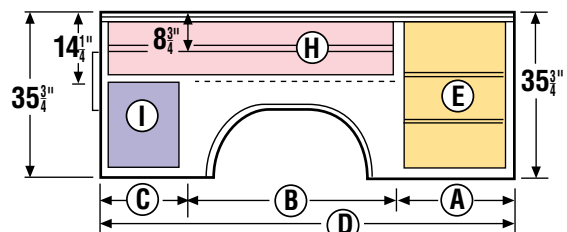

"B" Compartment Layout

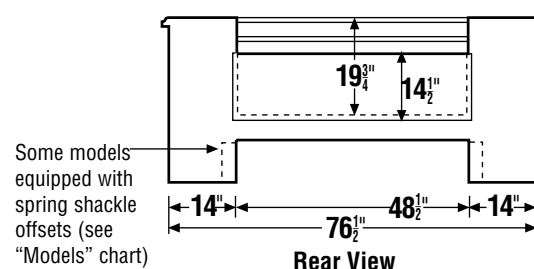

Rear View

Some models equipped with spring shackle offsets (see "Models" chart)

Standard shelf and divider equipment

All shelves removable, all dividers removable and adjustable. Dividers interchangeable on most shelves. **(8) shelves:** 78, 98, and 108 models. **(6) shelves:** LP78, LP98, and LP108 models. **(32) dividers:** 78, 98 models. **(40) dividers:** 108 models

All models available with:

"A" or "B" compartment layout both sides. Combination "AB" with "A" layout on roadside and "B" layout on curbside

"LP" denotes low profile model number. Bumpers are optional at additional cost

STANDARD BODIES – DUAL WHEEL

Model	Approx. Wt.		Cab-to-Axle	A	B	C	J	K	L	M	Approximate Compartment Clear Door Openings				
	Steel	Alum.									E	F	G	H	I
98-DW▲	1135#	625#	56"	93"	50"	21-1/2"	28"	48"	22"	98"	22-1/2"x35-1/4"	46-1/2"x14"	16-1/2"x35-1/4"	66-1/2"x14"	16-1/2"x18-1/8"
LP98-DW▲	1075#	591#	56"	93"	50"	21-1/2"	28"	48"	22"	98"	22-1/2"x30-1/4"	46-1/2"x9"	16-1/2"x30-1/4"	66-1/2"x9"	16-1/2"x18-1/8"
U108-DW	1252#	689#	60"	93"	50"	21-1/2"	34-3/4"	47"	26-1/4"	108"	29-1/4"x35-1/4"	45-1/2"x14"	20-3/4"x35-1/4"	69-3/4"x14"	20-3/4"x18-1/8"
ULP108-DW	1192#	656#	60"	93"	50"	21-1/2"	34-3/4"	47"	26-1/4"	108"	29-1/4"x30-1/4"	45-1/2"x9"	20-3/4"x30-1/4"	69-3/4"x9"	20-3/4"x18-1/8"
U1086-DW	1304#	717#	60"	93"	60"	16-1/2"	34-3/4"	47"	26-1/4"	108"	29-1/4"x35-1/4"	45-1/2"x14"	20-3/4"x35-1/4"	69-3/4"x14"	20-3/4"x18-1/8"
ULP1086-DW	1249#	687#	60"	93"	60"	16-1/2"	34-3/4"	47"	26-1/4"	108"	29-1/4"x30-1/4"	45-1/2"x9"	20-3/4"x30-1/4"	69-3/4"x9"	20-3/4"x18-1/8"

▲ Equipped with spring shackle offsets (see diagrams below). Contact your Reading Distributor for dimensions of offsets

Models 98DW, U108DW, and U1086DW

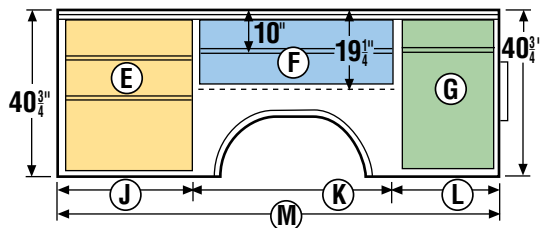

"A" Compartment Layout

Low Profile Models LP98-DW, ULP108-DW, and ULP1086-DW

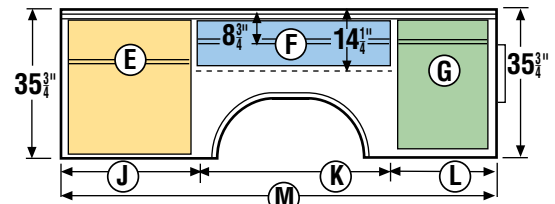

"A" Compartment Layout

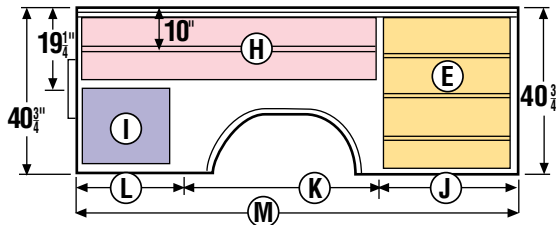

"B" Compartment Layout

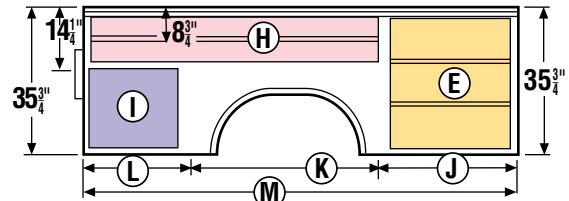

"B" Compartment Layout

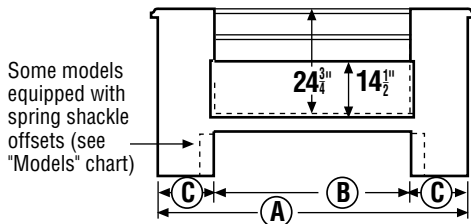

Rear View

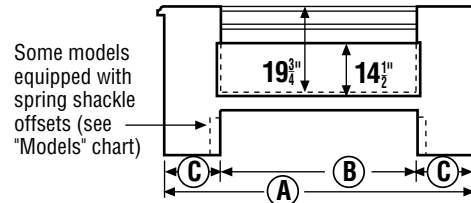

Rear View

Standard shelf and divider equipment

All shelves removable, all dividers removable and adjustable. Dividers interchangeable on most shelves. **(8) shelves:** 78, 98, and 108 models. **(6) shelves:** LP78, LP98, and LP108 models. **(32) dividers:** 78 and 98 models. **(40) dividers:** 108 models

All models available with:

"A" or "B" compartment layout both sides. Combination "AB" with "A" layout on roadside and "B" layout on curbside

"LP" denotes low profile model number

Bumpers are optional at additional cost

SPACEMAKER BODIES – SINGLE WHEEL

Model	Approx. Weight		Cab-to-Axle	A	B	C	D	Approximate Compartment Clear Door Openings				
	Steel	Alum.						E	F	G	H	I
**S78-SW▲	1018#	560#	40"	18"	42"	18"	78"	12-1/2"x35-1/4"	40-1/2"x14"	12-1/2"x35-1/4"	56-1/2"x14"	12-1/2"x18-1/8"
**SLP-78SW▲	978#	538#	40"	18"	42"	18"	78"	12-1/2"x30-1/4"	40-1/2"x9"	12-1/2"x30-1/4"	56-1/2"x9"	12-1/2"x18-1/8"
S98-SW▲	1189#	654#	56"	28"	48"	22"	98"	22-1/2"x35-1/4"	46-1/2"x14"	16-1/2"x35-1/4"	66-1/2"x14"	16-1/2"x18-1/8"
*US98-SW▲	1189#	654#	56"	28"	48"	22"	98"	22-1/2"x35-1/4"	46-1/2"x14"	16-1/2"x35-1/4"	66-1/2"x14"	16-1/2"x18-1/8"
SLP98-SW▲	1139#	626#	56"	28"	48"	22"	98"	22-1/2"x30-1/4"	46-1/2"x9"	16-1/2"x30-1/4"	66-1/2"x9"	16-1/2"x18-1/8"
*USLP98-SW▲	1139#	626#	56"	28"	48"	22"	98"	22-1/2"x30-1/4"	46-1/2"x9"	16-1/2"x30-1/4"	66-1/2"x9"	16-1/2"x18-1/8"
*US108-SW▲	1307#	719#	60"	34-3/4"	47"	26-1/4"	108"	29-1/4"x35-1/4"	45-1/2"x14"	20-3/4"x35-1/4"	69-3/4"x14"	20-3/4"x18-1/8"
*USLP108-SW▲	1257#	691#	60"	34-3/4"	47"	26-1/4"	108"	29-1/4"x30-1/4"	45-1/2"x9"	20-3/4"x30-1/4"	69-3/4"x9"	20-3/4"x18-1/8"

Installers notes:

- * Universal mounting
- ** E-Z mounting installation not available on these models
- ▲ Equipped with spring shackle offsets (see diagrams below). Contact your Reading Distributor for dimensions of offsets

Models S78-SW, S98-SW, US98-SW, and US108-SW

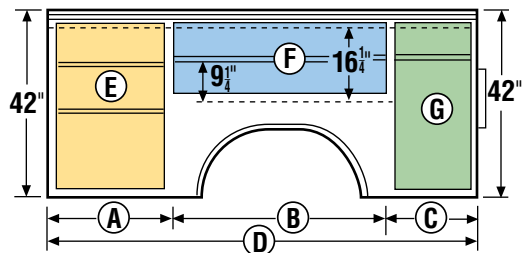

"A" Compartment Layout

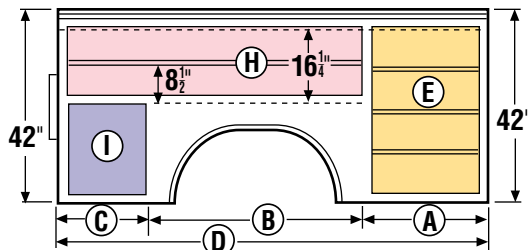

"B" Compartment Layout

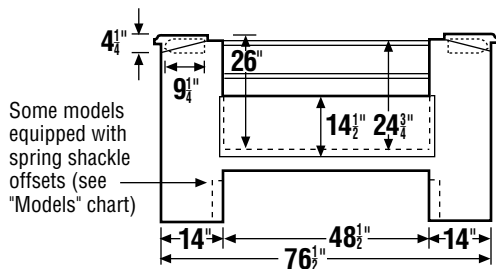

Rear View

Some models equipped with spring shackle offsets (see "Models" chart)

Low Profile Models SLP78-SW, SLP98-SW, USLP98-SW, and USLP108-SW

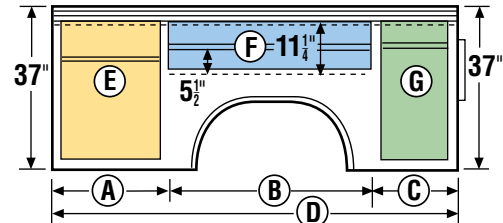

"A" Compartment Layout

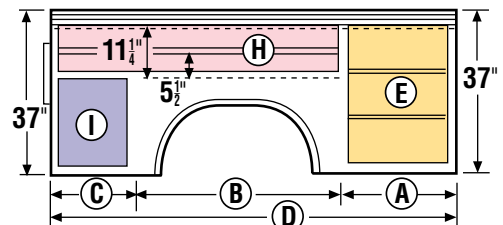

"B" Compartment Layout

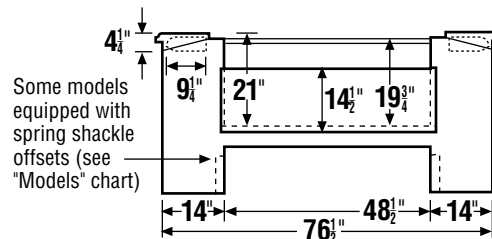

Rear View

Some models equipped with spring shackle offsets (see "Models" chart)

Standard shelf and divider equipment

All shelves removable, all dividers removable and adjustable. Dividers interchangeable on most shelves. **(8) shelves:** 78, 98, and 108 models. **(6) shelves:** LP78, LP98, and LP108 models. **(32) dividers:** 78 and 98 models. **(40) dividers:** 108 models. **Each top compartment has 15 dividers**

All models available with:

"A" or "B" compartment layout both sides. Combination "AB" with "A" layout on roadside and "B" layout on curbside

"LP" denotes low profile model number

Bumpers are optional at additional cost

SPACEMAKER BODIES – DUAL WHEEL

Model	Approx. Wt.		Cab-to-Axle	A	B	C	D	J	K	L	M	Approximate Compartment Clear Door Openings				
	Steel	Alum.										E	F	G	H	I
S98-DW▲	1377#	757#	56"	93"	50"	21-1/2"	13-1/4"	28"	48"	22"	98"	22-1/2"x35-1/4"	46-1/2"x14"	16-1/2"x35-1/4"	66-1/2"x14"	16-1/2"x18-1/8"
SLP98-DW▲	1317#	724#	56"	93"	50"	21-1/2"	13-1/4"	28"	48"	22"	98"	22-1/2"x30-1/4"	46-1/2"x9"	16-1/2"x30-1/4"	66-1/2"x9"	16-1/2"x18-1/8"
US108-DW	1442#	793#	60"	93"	50"	21-1/2"	13-1/4"	34-3/4"	47"	26-1/4"	108"	29-1/4"x35-1/4"	45-1/2"x14"	20-3/4"x35-1/4"	69-3/4"x14"	20-3/4"x18-1/8"
USLP108-DW	1382#	760#	60"	93"	50"	21-1/2"	13-1/4"	34-3/4"	47"	26-1/4"	108"	29-1/4"x30-1/4"	45-1/2"x9"	20-3/4"x30-1/4"	69-3/4"x9"	20-3/4"x18-1/8"
US1086-DW	1566#	861#	60"	93"	60"	16-1/2"	9-1/4"	34-3/4"	47"	26-1/4"	108"	29-1/4"x35-1/4"	45-1/2"x14"	20-3/4"x35-1/4"	69-3/4"x14"	20-3/4"x18-1/8"
USLP1086-DW	1511#	831#	60"	93"	60"	16-1/2"	9-1/4"	34-3/4"	47"	26-1/4"	108"	29-1/4"x30-1/4"	45-1/2"x9"	20-3/4"x30-1/4"	69-3/4"x9"	20-3/4"x18-1/8"

▲ Equipped with spring shackle offsets (see diagrams below). Contact your Reading Distributor for dimensions of offsets

Models S78-DW, S98-DW, US98-DW, and US108-DW

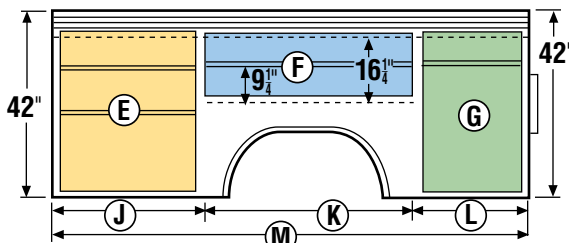

"A" Compartment Layout

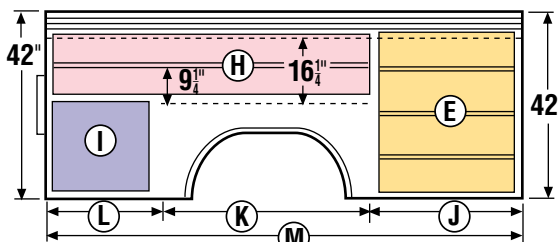

"B" Compartment Layout

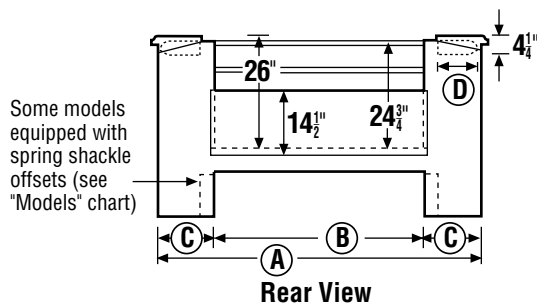

Rear View

Low Profile Models SLP78-DW, SLP98-DW, USLP98-DW, and USLP108-DW

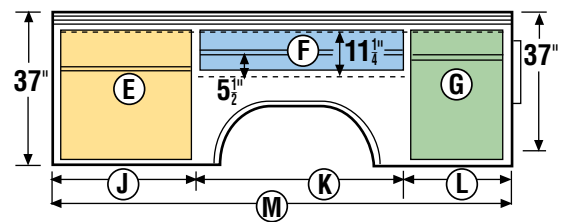

"A" Compartment Layout

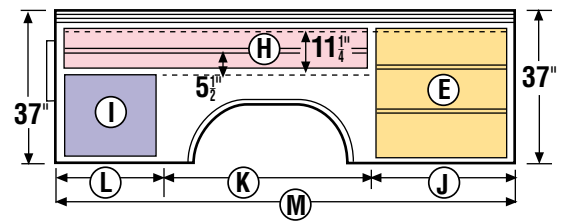

"B" Compartment Layout

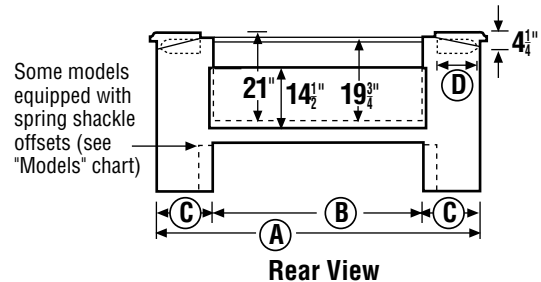

Rear View

Standard shelf and divider equipment

All shelves removable, all dividers removable and adjustable. Dividers interchangeable on most shelves. **(8) shelves:** 78, 98, and 108 models. **(6) shelves:** LP78, LP98, and LP108 models. **(32) dividers:** 78 and 98 models. **(40) dividers:** 108 models. **Each top compartment** has 15 dividers.

All models available with:

"A" or "B" compartment layout both sides. Combination "AB" with "A" layout on roadside and "B" layout on curbside.

"LP" denotes low profile model number.

Bumpers are optional at additional cost.

Floor area 42" clear between wheel boxes. NO WHEEL BOXES ON 98-DW OR 108-DW MODELS.

132 BODIES AND SPACEMASTER TOPS

132 Bodies

Model	Approx. Wt.	Cab-to-Axle	Approximate Clear Door Openings						
			A	B	C	D	E	F	G
UR132AB-DW	1600#	84"	22-1/2"x35-1/4"	48-1/4"x14"	20-3/4"x35-1/4"	72-1/2"x14"	20-3/4"x18-1/8"	35"x35-1/4"	11-1/2"x35-1/4"
ULPR132AB-DW	1515#	84"	22-1/2"x30-1/4"	48-1/4"x9"	20-3/4"x30-1/4"	72-1/2"x9"	20-3/4"x18-1/8"	35"x30-1/4"	11-1/2"x30-1/4"
USR132AB-DW	1831#	84"	22-1/2"x35-1/4"	48-1/4"x14"	20-3/4"x35-1/4"	72-1/2"x14"	20-3/4"x18-1/8"	35"x35-1/4"	11-1/2"x35-1/4"
USLPR132AB-DW	1746#	84"	22-1/2"x30-1/4"	48-1/4"x9"	20-3/4"x30-1/4"	72-1/2"x9"	20-3/4"x18-1/8"	35"x30-1/4"	11-1/2"x30-1/4"

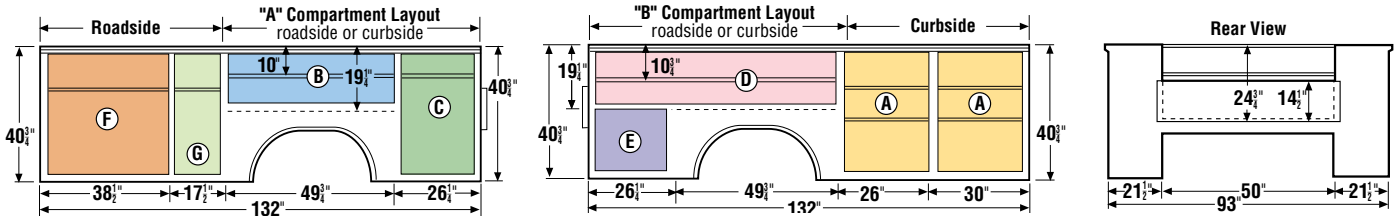

LP132AB-DW height : same as LP108

S132AB-DW and SLP132AB-DW height: same as S108 and SLP108

Optional crane reinforcement available at added cost upon request. Reading also manufactures "Cranemaster" bodies which are specifically engineered for crane use. See separate literature or Reading's website for specifications on Reading's Cranemaster 6000 and 8000 bodies.

Standard shelf and divider equipment

All shelves and dividers removable and adjustable. (9) shelves and (40) dividers included

Spacemaster Tops

Standard shelf and divider equipment

All models feature 1 shelf and 4 dividers in curbside front compartment only
Shelves are removable and dividers are adjustable and removable

Model	Approx. Weight*		Cab-to-axle	A	B	F	G	H	I	J	K
	Steel	Alum.									
SPM48-98SW**	599#	303#	56"	98"	49"	62-1/2"	13-1/4"	48-1/2"	7-1/2"	75"	8-1/2"x42-3/4"
SPM57-98SW**	641#	348#	56"	98"	49"	62-1/2"	13-1/4"	48-1/2"	7-1/2"	75"	12-1/2"x42-3/4"
SPM48-98DW	641#	353#	56"	98"	49"	74"	18-1/4"	50"	11"	86-1/2"	8-1/2"x42-3/4"
SPM57-98DW	722#	397#	56"	98"	49"	74"	18-1/4"	50"	11"	86-1/2"	12-1/2"x42-3/4"
SPM48-U108SW**	583#	316#	60"	108"	54"	62-1/2"	13-1/4"	48-1/2"	7-1/2"	75"	8-1/2"x48-3/4"
SPM57-U108SW**	673#	366#	60"	108"	54"	62-1/2"	13-1/4"	48-1/2"	7-1/2"	75"	12-1/2"x48-3/4"
SPM48-U108DW	668#	367#	60"	108"	54"	74"	18-1/4"	50"	11"	86-1/2"	8-1/2"x48-3/4"
SPM57-U108DW	758#	417#	60"	108"	54"	74"	18-1/4"	50"	11"	86-1/2"	12-1/2"x48-3/4"
SPM57-UR132DW	985#	—	84"	132"	42"▲	80"	18-1/4"	50"	11"	92"	12-1/2"x39-1/4"
SPM57-UR132HDDW	985#	—	84"	132"	42"▲	80"	18-1/4"	50"	11"	92"	12-1/2"x39-1/4"

*Denotes Spacemaster top weight only. **Available factory installed only.

▲ NOTE: SPM57-UR132 and SPM57-UR132HD have (3) "K" compartments each side, equally spaced

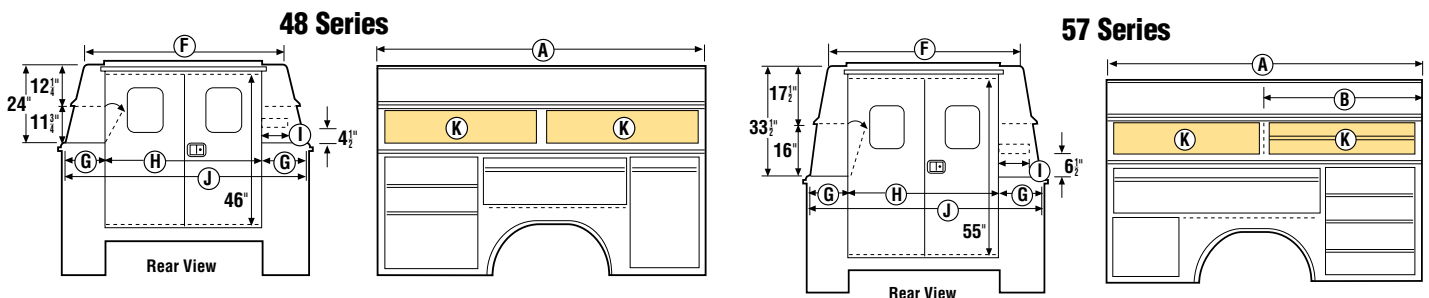

Dimensions and specifications for lower compartment areas correspond to Reading service bodies with equivalent model numbers (minus prefix SPM48 or SPM57) shown above

HEAVY-DUTY BODIES

Model	Approx. Wt.	Cab-to-axle	Approximate Compartment Clear Door Openings						
			A	B	C	D	E	F	G
HDR108AB	1414#	60"	29-1/4"x38-1/2"	45-1/2"x14"	20-3/4"x38-1/2"	69-3/4"x14"	20-3/4"x21-3/8"	—	—
HDR120AB	1761#	72"	36-1/2"x38-1/2"	48-1/2"x14"	20-3/4"x38-1/2"	72-1/2"x14"	20-3/4"x21-3/8"	—	—
HDR132AB	2182#	84"	22-1/2"x38-1/2"	48-1/4"x14"	20-3/4"x38-1/2"	72-1/2"x14"	20-3/4"x21-3/8"	35"x21-3/8"	11-1/2"x38-1/2"
HDR150AB	2536#	102"	20-1/2"x38-1/2"	48-1/4"x14"	20-3/4"x38-1/2"	72-1/2"x14"	20-3/4"x21-3/8"	—	—

Heavy duty bodies are designed for chassis 1½ ton and over with dual rear wheels

HD108AB "A" Compartment Layout

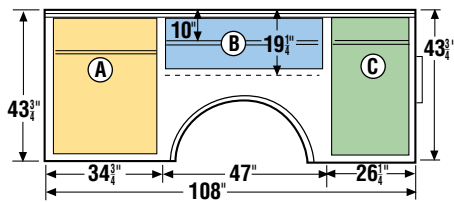

"B" Compartment Layout

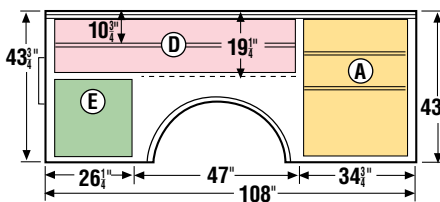

Rear View

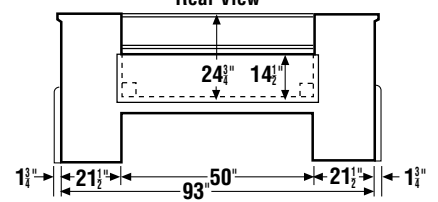

Floor area 42" clear between wheel boxes

HD120AB "A" Compartment Layout

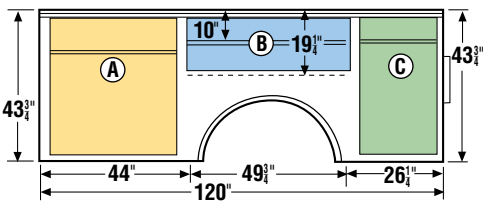

"B" Compartment Layout

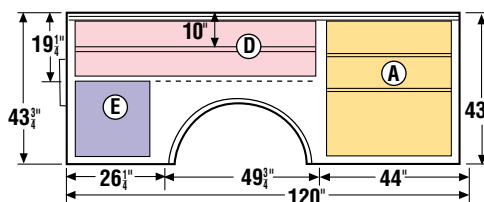

Rear view same as HD108AB

HD132AB

"A" Compartment Layout

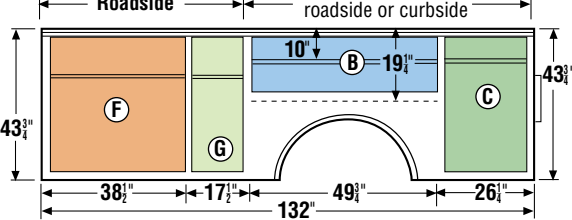

"B" Compartment Layout

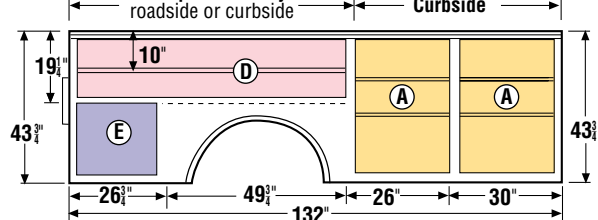

Rear view same as HD108AB

HD150AB

"A" Compartment Layout

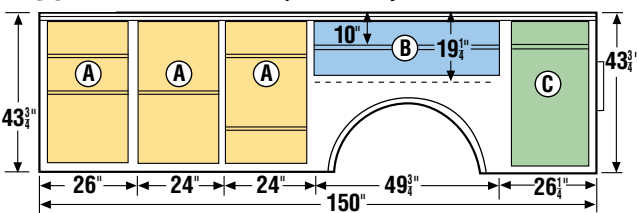

"B" Compartment Layout

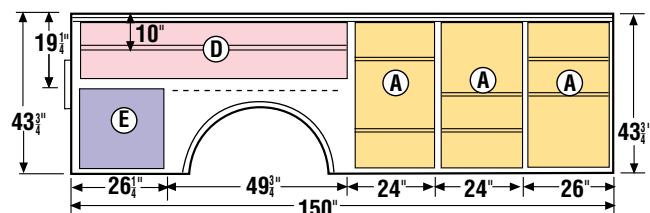

Rear view same as HD108AB

Standard shelf and divider equipment

All shelves and dividers removable and adjustable. (6) shelves HD108 model, (6) shelves HD120 model, (9) shelves HD132 model, (14) shelves HD150 model

Dividers: A total of 40 dividers

Bumpers are optional equipment available at additional cost.

Optional crane reinforcement available at added cost upon request. Reading also manufactures Cranemaster bodies which are specifically engineered for crane use. See separate literature or Reading's website for specifications on Reading's Cranemaster 6000 and 8000 bodies

PANEL TOPS

Dimensions and specifications for lower compartment areas correspond to Reading service bodies with equivalent model numbers (minus prefix PA/TPA-50, PA/TPA-60, or PA/TPA-72) shown below

50 Series – 50" inside head clearance						
Model	Approximate Weight*		Dimensions			
	Steel	Alum.	A	B	C	Length
PA50-98SW**	425#	224#	63-1/2"	7-1/2"	48-1/2"	98"
TPA50-98SW**	469#	276#	64"	7-3/4"	48-1/2"	98"
PA50-98-DW	528#	258#	76"	13"	50"	98"
TPA50-98DW	572#	278#	76-1/2"	13-1/4"	50"	98"
PA50-108SW**	440#	233#	63-1/2"	7-1/2"	48-1/2"	108"
TPA50-108SW**	484#	253#	64"	7-3/4"	48-1/2"	108"
PA50-108DW	551#	267#	76"	13"	50"	108"
TPA50-108DW	595#	287#	76-1/2"	13-1/4"	50"	108"
PA50-1086DW	561#	279#	75"	7-1/2"	60"	108"
TPA50-1086DW	601#	297#	76-1/2"	8-1/4"	60"	108"

*Denotes panel top weight only

**Available factory installed only

60 Series – 60" inside head clearance						
Model	Approximate Weight*		Dimensions			
	Steel	Alum.	A	B	C	Length
PA60-98SW**	480#	224#	63-1/2"	7-1/2"	48-1/2"	98"
TPA50-98SW**	524#	276#	64"	7-3/4"	48-1/2"	98"
PA50-98-DW	615#	258#	76"	13"	50"	98"
TPA50-98DW	659#	278#	76-1/2"	13-1/4"	50"	98"
PA50-108SW**	515#	233#	63-1/2"	7-1/2"	48-1/2"	108"
TPA50-108SW**	559#	253#	64"	7-3/4"	48-1/2"	108"
PA50-108DW	660#	267#	76"	13"	50"	108"
TPA50-108DW	704#	287#	76-1/2"	13-1/4"	50"	108"
PA50-1086DW	670#	279#	75"	7-1/2"	60"	108"
TPA50-1086DW	710#	297#	76-1/2"	8-1/4"	60"	108"
PA60-108HD	646#	—	76"	13"	50"	108"
TPA60-108HD	690#	—	76-1/2"	13-1/4"	50"	108"
PA60-120HD	721#	—	76"	13"	50"	120"
TPA60-120HD	771#	—	76-1/2"	13-1/4"	50"	120"
PA60-132	820#	—	76"	13"	50"	132"
TPA60-132	874#	—	76-1/2"	13-1/4"	50"	132"
PA60-132HD	820#	—	76"	13"	50"	132"
TPA60-132HD	874#	—	76-1/2"	13-1/4"	50"	132"
PA60-150HD	929#	—	76"	13"	50"	150"
TPA60-150HD	990#	—	76-1/2"	13-1/4"	50"	150"

*Denotes panel top weight only

**Available factory installed only

72 Series – 72" inside head clearance						
Model	Approximate Weight*		Dimensions			
	Steel	Alum.	A	B	C	Length
PA72-108DW*	734#	373#	76"	13"	50"	108"
TPA72-108DW	782#	395#	76-1/2"	13-1/4"	50"	108"
PA72-1086DW	744#	385#	75"	7-1/2"	50"	108"
TPA72-1086DW	784#	403#	76-1/2"	8-1/4"	50"	108"
PA72-108HD	789#	—	76"	13"	50"	108"
TPA72-108HD	833#	—	76-1/2"	13-1/4"	50"	108"
PA72-120HD	888#	—	76"	13"	50"	120"
TPA72-120HD	938#	—	76-1/2"	13-1/4"	50"	120"
PA72-132	972#	—	76"	13"	50"	132"
PA72-132	1026#	—	76-1/2"	13-1/4"	50"	132"
PA72-132HD	972#	—	76"	13"	50"	132"
TPA72-132HD	1026#	—	76-1/2"	13-1/4"	50"	132"
PA72-150HD	1082#	—	76"	13"	50"	150"
TPA72-150HD	1143#	—	76-1/2"	13-1/4"	50"	150"

*Denotes panel top weight only

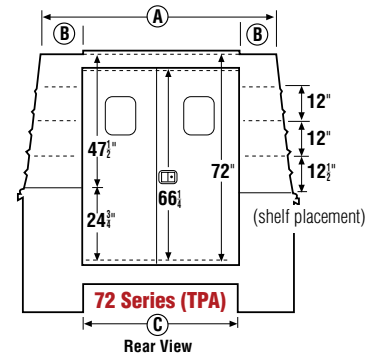
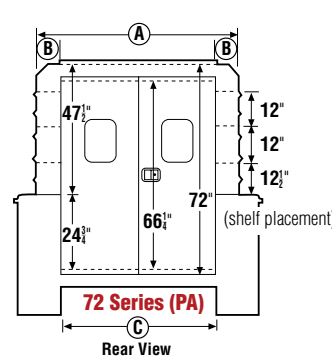
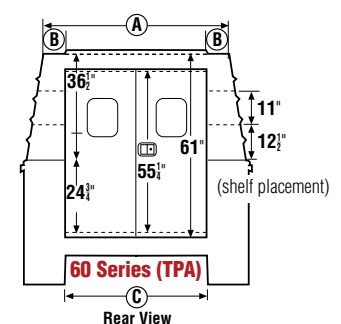
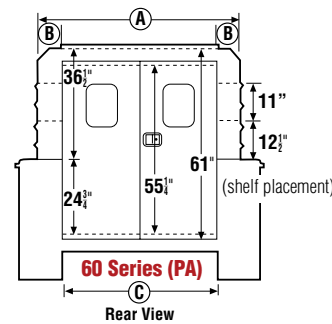
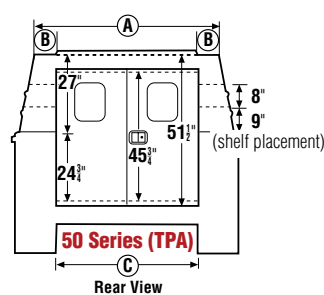
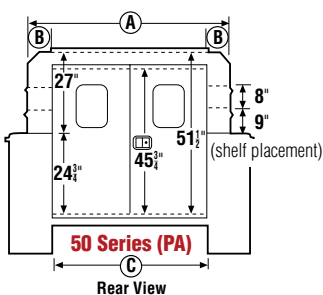

ADDITIONAL OPTIONS



L.E.D. LIGHTING

- Bright, long lasting L.E.D. lights are available



MASTER LOCKING

- Steel slide bar simultaneously locks all of the compartment doors on a service body's side
- Spring loaded for easy manual operation



ALUMA-CHOCK®

- Aluminum chock block holders
- Can be ordered as single or dual per body side
- Protects the body from nicks and scratches from repeated insertion and removal of chock blocks

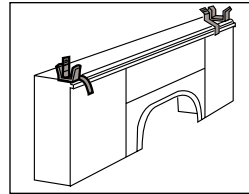

PIPE VISE RACK

- Rugged steel construction
- Holds pipe sections securely in place

STEEL LADDER RACKS

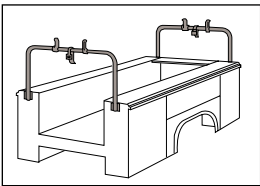

Removable overhead ladder rack

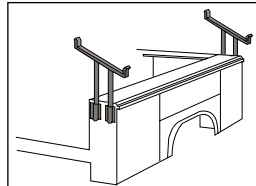

Removable side mount ladder rack (angular rack shown, flat rack also available)

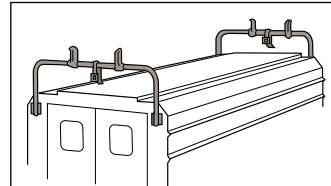

Removable overhead ladder rack for panel body

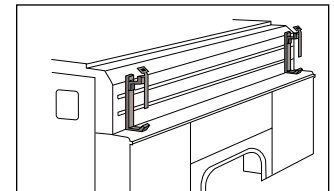

Side mount ladder rack for panel body

STEEL SLIDING TOPS

- Available in two or three sections (depending on body size)
- Slides on full-length galvanized steel tracks
- Secured with a two-point positive action stainless steel T-handle lock



Models
ST78 - ST108HD

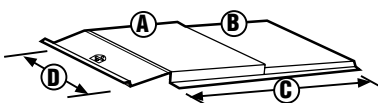

Models
ST120HD - ST150HD

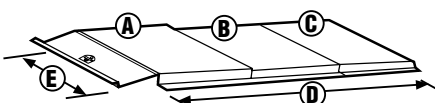

Model	For Body	Approx. Wt. (lbs.)	
		Steel	Alum.
ST-78	78SW	145	80
ST-98	98SW	155	86
ST-98D	98DW	160	90
ST-108	108SW	170	95
ST-108D	108DW	175	100
ST-1086D	1086DW	225	124
ST-108HD	HD-108	225	—
ST-120HD	HD-120	350	—
ST-132HD	HD-132	370	—
ST-150HD	HD-150	410	—

Model	A	B	C	D	E
ST98	49-3/4"	47-3/4"	102"	50-7/8"	—
ST98D	49-3/4"	47-3/4"	102"	52-3/8"	—
ST108	55-1/4"	52-1/4"	107-1/2"	50-7/8"	—
ST108D	55-1/4"	52-1/4"	107-1/2"	52-3/8"	—
ST1086D	55-1/4"	52-1/4"	107-1/2"	62-3/8"	52-3/8"
ST108HD	55-1/4"	53-7/8"	107-1/2"	52-3/8"	—
ST120HD	40-3/4"	40-3/4"	40"	119-3/4"	52-3/8"
ST132HD	44-3/4"	44-3/4"	44"	131-3/4"	52-3/8"
ST150HD	50-3/4"	50-3/4"	50"	149-3/4"	52-3/8"

MATERIAL RACK

- Heavy gauge square tubing
- Constructed from 1/8" wall thickness, 1-1/2" x 1-1/2" and 2" x 2" high-strength steel square tubing
- Optional 11" extension available for taller cabs
- Universally designed rack fits single wheel and dual wheel service bodies from 98" up to and including 132" lengths
- High gloss black powder coat finish
- 1200 lb. Capacity



* Payload will effect vehicle handling
** Cannot be used with a sliding top



Ready Van



Classic Service Van (CSV)



SL Service Bodies



Aluminum Service Bodies



Crane Bodies



Landscape Body



Forestry Body



Dump Body



Redi-Dek



Platform Bodies



Drop Side Dump Body

Sold and serviced locally by:

EXPECT MORE. CHOOSE READING.



800.458.2226 | www.readingbody.com

Reading, Aluma-Fill, Aluma Chock, Grip-'n-Glide, and Latchmatic are registered trademarks and Classic II, is a trademark of Reading Truck Body, LLC in the United States and in some foreign countries.

©2009 Reading Truck Body, LLC. All dimensions subject to plus or minus tolerance of 1/4" and all dimensions and specifications are subject to change without notice. Please note that some items shown in photographs are optional. RTB09-CII-10M-02